



Revisions		Approved	Date
Description/Approve/Date	Checked	M.H.	Date
	Drawn	K.R.E.	11/17/06

Tolerances
 1-20=+/-0.2
 20-30=+/-0.3
 30-40=+/-0.4
 40-50=+/-0.5
 50-100=+/-0.75
 100-300=+/-1.5
 Angles=+/-1

Dimensions are in Millimeters

NOTES (plating thickness in microinches):
 1. Per QQ-B-626
 2. Per QQ-S-764
 3. Per QQ-C-530
 4. Per QQ-B-750
 5. Per MIL-P-19488
 6. Per ZZ-R-765
 7. Per WW-1-799
 8. Gold pl. 5 min. over nickel pl. 50 min. over copper strike
 9. Nickel pl. 100 min. over copper strike
 10. Per QQ-P-35
 11. Gold pl. 30 min. over nickel pl. 50 min. over copper strike

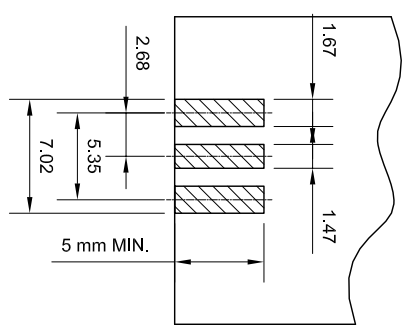
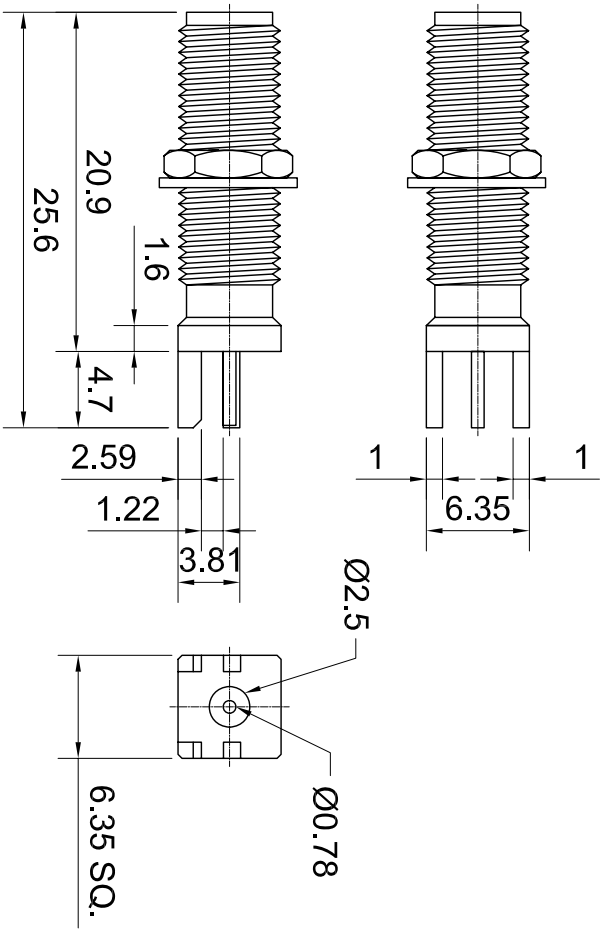

LANDING PAD DIMENSIONS

ITEM	MATERIAL	FINISH
Connector Body	Brass, Note 1	Gold, Note 8
Center Contact: Female	BeCu, Note 3	Gold, Note 11
Insulation	Teflon, Note 5	None
Ferrule	--	--
Gasket	--	--
Hex Nut	Brass, Note 1	Same as body
Lock Washer	Brass, Note 1	Same as body

Lighthorse Technologies, Inc.
 5640 Kearny Mesa Road, Suite N
 San Diego, CA 92111
 Part Number:
LTI-SASF55LGT-4

Description SMA end launch jack (long version) for 40 mil board.		
Scale	Drawing No.	File Name
3:1		SASF55LGT-4